

*Vijay Sagar Mishra*

Chairman



Chairman, Rishra Municipality

Phone: 2672-1373

2672-2953

Mobile: 9433016621

Fax : 2672-0306

E-mail : rishramunicipality@yahoo.com

Ref. No. : 1537/VIII

Date : 13.9.19

To

M/s Offlix E-Marketing LIP,  
86B/2, Topsia Road,  
Gajraj Chambers,  
3<sup>rd</sup> Floor, Room No. 3D,  
Kolkata - 700 046

M/s Padmawati Infrearealty Pvt. Ltd.  
1, R.N. Mukherjee Road,  
Martin Burn Building,  
3<sup>rd</sup> Floor, Room No. 310,  
Kolkata - 700 001

Ref: - Your Ref No RIS/PLSAN/2019-20/01

Sir,

Please refer to above.

Your prayer dated 5<sup>th</sup> August' 2019 was placed in the meeting of the Board of Councillors held on 30.8.2019. Consequesnt upon the decision of the meeting you are hereby advised to proceed for laying out the plots of holding no 103/3, S.C. Aown Road, Rishra Hooghly L.R Dag No 9169 L.R. Khatian No 1011 J.L No 27 under Mouja Rishra after observing all required/necessary formalities.

Yours faithfully

Chairman, *13/9/19*  
Rishra Municipality

Offlix E-marketing LLP

*Rishra Shreegumals*

Designated Partner

Padmawati Infrearealty (P) Ltd.

*S. Halder*

Director



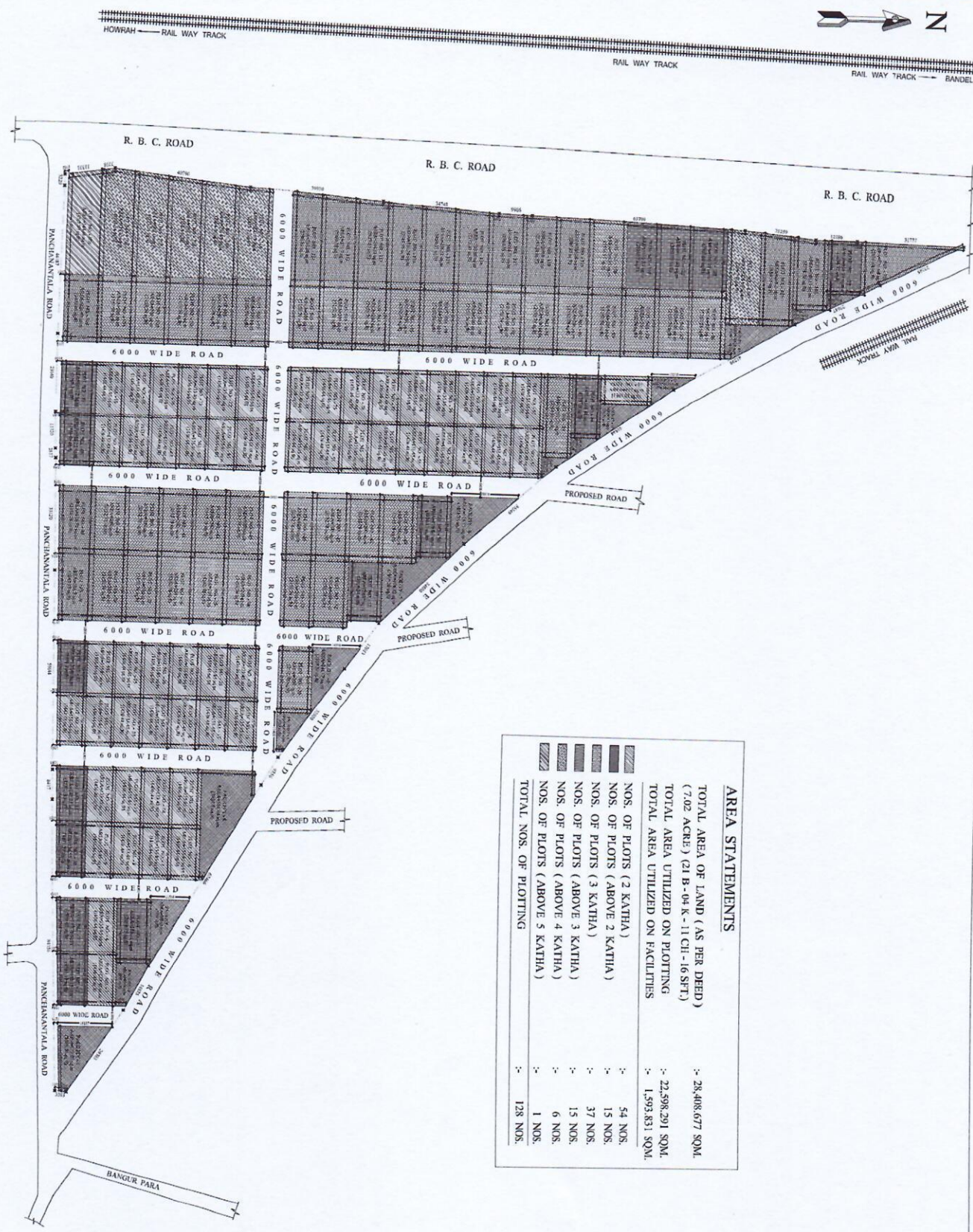

**AREA STATEMENTS**

TOTAL AREA OF LAND (AS PER DEED) (7.02 ACRES) (21 B - 04 K - 11 CH - 16 SFT)	: 28,408,677 SQM.
TOTAL AREA UTILIZED ON PLOTTING	: 22,598,291 SQM.
TOTAL AREA UTILIZED ON FACILITIES	: 1,595,831 SQM.
NOS. OF PLOTS (2 KATHA)	: 54 NOS.
NOS. OF PLOTS (ABOVE 2 KATHA)	: 15 NOS.
NOS. OF PLOTS (3 KATHA)	: 37 NOS.
NOS. OF PLOTS (ABOVE 3 KATHA)	: 15 NOS.
NOS. OF PLOTS (ABOVE 4 KATHA)	: 6 NOS.
NOS. OF PLOTS (ABOVE 5 KATHA)	: 1 NOS.
TOTAL NOS. OF PLOTTING	: 128 NOS.

PRODUCED BY AN AUTODESK EDUCATIONAL PRODUCT

PRODUCED BY AN AUTODESK EDUCATIONAL PRODUCT

NAME OF OWNER OFFLIN E-MARKETING LLP AND PADMAWATI INFRAREALTY PVT. LTD.	SIGNATURE OF OWNER
PROJECT PROPOSED PLOT LAYOUT FOR OFFLIN E-MARKETING LLP AND PADMAWATI INFRAREALTY PVT. LTD. AT HOLDING NO. - 10/3, S. C. JOMNY ROAD, UNDER DIST. - JODHPUR UNDER R. S. DAG 1/5 - 2815 TO 2823, 2825, 2828 TO 2833, 2835, 2836, 2800 TO 2907, 2909 TO 2912 & R. S. KHATTAN NO. - 2767, 2186, 2028, 422, 128 (1/6), 1422 (2/3), 1281, 1286, 1111, 1112, 1113, 1114, 1115, 1116, 1117, 3865, 1791, 381, 1692.	SIGNATURE OF ARCHITECT
ARCHITECT R. S. JODHPUR & ASSOCIATES R. S. JODHPUR - 15	

Office E-marketing LLP

Padmawati Infra Realty (P) Ltd.

Rishu Singhania  
Designated Partner

S. Halder  
Director

